



COMMERCIAL AND ARCHITECTURAL  
DOOR MANUFACTURER

U.S.A. : 1 800 363.2248  
Can. : 1 800 463.3124  
info@lambtondoors.com

## COMMERCIAL AND ARCHITECTURAL DOORS

EnviroDesign  
SERIES NO UREA™

Mineral core  
**45 minute fire rating**  
NO UREA FORMALDEHYDE

Compatible edge **5-FD45-ECE**  
Matching edge **5-FD45-EME**

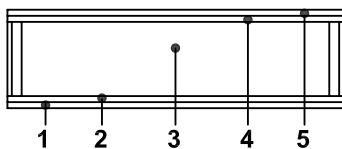
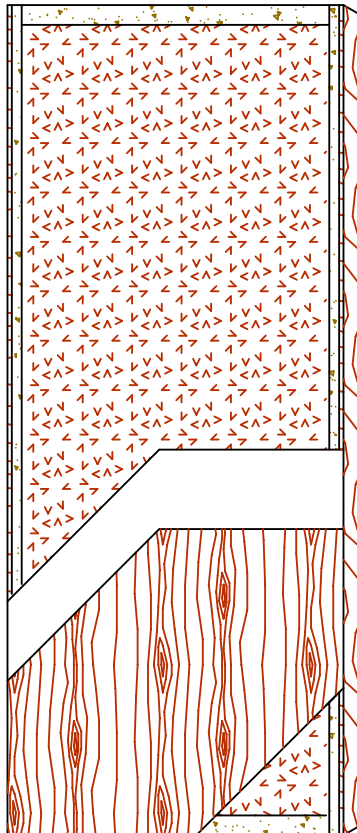

### SPECIFICATIONS

### DESCRIPTION

|  |  |
|--|--|
| <b>Type</b>                                  | Mineral core (interior use).   |
| <b>In conformity with industry standards</b> | ARCHITECTURAL WOODWORK STANDARDS-ED.1<br>W.D.M.A. SERIES I.S.1-A-2004  |
| <b>Thickness</b>                             | 1-3/4" (44 mm).  |
| <b>Maximum size</b>                          | 48" x 120" (1 219 mm x 3 048 mm).  |
| <b>Stiles</b>                                | <b>ECE:</b> 7/16" (11 mm) wood (mill option) laminated to 1" (25 mm) proprietary material (FPCM)*.<br><b>EME:</b> 7/16" (11 mm) hardwood laminated to 1" (25 mm) proprietary material (FPCM)*. |
| <b>Rails</b>                                 | 2" (51 mm) proprietary material (FPCM)*.   |
| <b>Core</b>                                  | Non-combustible mineral core.  |
| <b>Adhesive</b>                              | Type I (waterproof); PVA (no urea formaldehyde);<br><b>VOC&lt;0.683 g/L.</b>   |
| <b>Face</b>                                  | Wood veneer, HDF or MDO bonded to a UF free composite crossband.<br><b>No added urea formaldehyde resin.</b>   |
| <b>Options</b>                               | <ul style="list-style-type: none"> <li>● Neutral or positive pressure.</li> <li>● Blocking for hardware.</li> </ul> Refer to Fire Door Section of our website for details.                     |
| <b>Lite and louver opening</b>               | Cut-out for lite and louver with size limitations.<br>Refer to Options Section of our website for details.   |
| <b>Notes</b>                                 | Stile and rail dimensions shown are rough sizes, before trimming. Dimensions will vary due to prefit requirements.   |
| <b>Warranty</b>                              | Life of original installation.<br>See our complete warranty for details.   |
| <b>Factory finish</b>                        | UV Finishing System. Stain, clearcoat, opaque and primed finish available. Custom color matching available. Seal top and bottom standard. <b>No VOC.</b>                                       |
| <b>Environmental description</b>             | Low Emitting Materials ( <b>LEED EQc4.4</b> ).   |

\* Fire Proof Composite Material

### INFORMATION

[www.lambtondoors.com](http://www.lambtondoors.com)



ARCHITECTURAL  
WOODWORK  
INSTITUTE

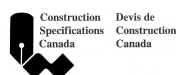

Devis de  
Construction  
Canada

Printed in Canada 2010/12