



COMMERCIAL AND ARCHITECTURAL
DOOR MANUFACTURER

U.S.A. : 1 800 363.2248
Can. : 1 800 463.3124
info@lambtondoors.com

COMMERCIAL AND ARCHITECTURAL DOORS

Laminated strand lumber core

Compatible edge **5-LSL-CE**

Matching edge **5-LSL-ME**

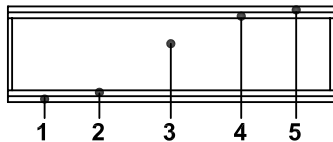
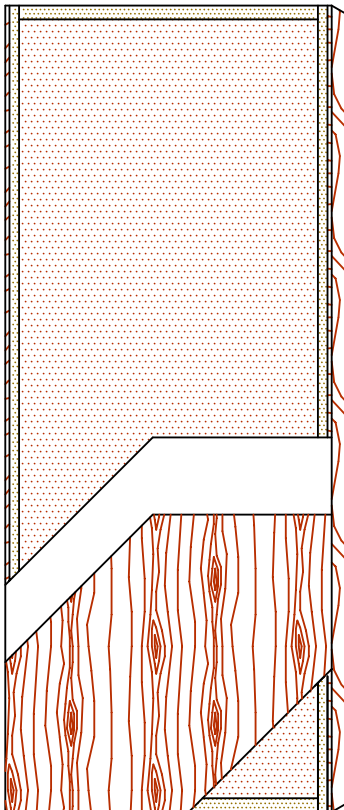

SPECIFICATIONS DESCRIPTION

Type	Laminated strand lumber core (interior use).
In conformity with industry standards	ARCHITECTURAL WOODWORK STANDARDS-ED.1 W.D.M.A. SERIES I.S.1-A-2004 ASTM D5456-09
Thickness	1-3/8" (35 mm) – 1-3/4" (44 mm), 2" (51 mm) – 2-1/4" (57 mm).
Maximum size	48" x 120" (1 219 mm x 3 048 mm).
Stiles	CE: 7/16" (11 mm) wood (mill option) laminated to 1" (25 mm) structural composite lumber (SCL). ME: 7/16" (11 mm) hardwood laminated to 1" (25 mm) structural composite lumber (SCL).
Rails	1-7/16" (36 mm) structural composite lumber (SCL).
Core	Structural composite lumber (SCL) with a density of 38 PCF (609 kg/m ³) bonded to the stiles.
Adhesive	Type I (waterproof); PVA (no urea formaldehyde); VOC<0.683 g/L.
Face	Wood veneer or MDO bonded to a composite crossband.
Options	<ul style="list-style-type: none"> ● [Door 1-3/4"- (44 mm)] 20 minute rating neutral or positive pressure. Refer to Fire Door Section of our website for details. ● 15/16" (24 mm) wood (mill option) or hardwood laminated to 1" (25 mm) structural composite lumber (SCL).
Lite and louver openings	Wood louvers not permitted in 20 minute labeled doors. Minimum 5" (127 mm) from stiles or rails. Minimum 1-1/2" (38 mm) from cut-out to cut-out. Refer to Option Section of our website for details.
Notes	Stile and rail dimensions shown are rough sizes, before trimming. Dimensions will vary due to prefit requirements.
Warranty	Life of original installation. See our complete warranty for details.
Factory Finish	UV Finishing System. Stain, clearcoat, opaque and primed finish available. Custom color matching available. Seal top and bottom standard. No VOC.



INFORMATION

www.lambtondoors.com

Printed in Canada 2010/12