

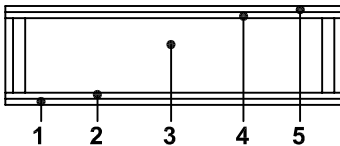

COMMERCIAL AND ARCHITECTURAL  
DOOR MANUFACTURER

U.S.A. : 1 800 363.2248  
Can. : 1 800 463.3124  
sales@lambtondoors.com

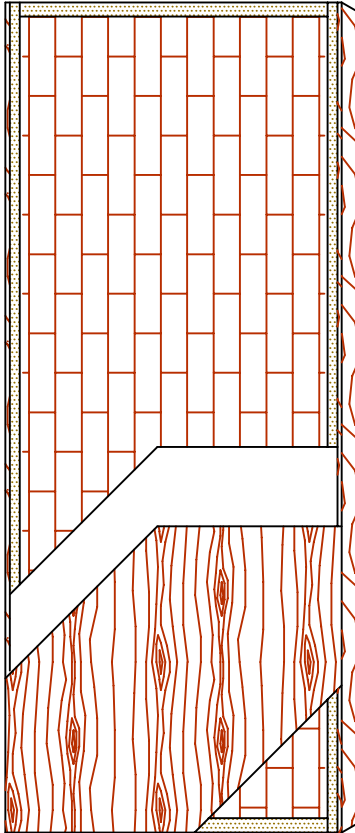

## COMMERCIAL AND ARCHITECTURAL DOORS



**Stave lumber core**  
**FSC CERTIFIED**

**NO UREA FORMALDEHYDE**

Compatible edge **5-FSLC-ECE**

Matching edge **5-FSLC-EME**

SPECIFICATIONS	DESCRIPTION
Type	FSC Certified Stave Lumber Core (interior use).
In conformity with industry standards	ARCHITECTURAL WOODWORK STANDARDS-ED.1 W.D.M.A. SERIES I.S.1-A-2004 CSA 0132.2 SERIES 90 ASTM D5456-09
Thickness	1-3/4" (44 mm).
Maximum size	48" x 108" (1 219 mm x 2 743 mm).
Stiles	<b>ECE:</b> 7/16" (11 mm) wood (mill option) laminated to 1" (25 mm) structural composite lumber (SCL). <b>EME:</b> 7/16" (11 mm) hardwood laminated to 1" (25 mm) structural composite lumber (SCL).
Rails	1-7/16" (36 mm) structural composite lumber (SCL).
Core	Random lengths of low-density wood blocks bonded to the stiles and rails. <b>No added urea formaldehyde resins. FSC certified.</b>
Adhesive	Type I (waterproof); PVA (no urea formaldehyde); <b>VOC&lt;0.683 g/L.</b>
Face	Wood veneer or MDO bonded to a UF free composite crossband. <b>No added urea formaldehyde resins.</b>
Option	<ul style="list-style-type: none"> <li>● 20 minute rating neutral or positive pressure. Refer to Fire Door Section of our website for details.</li> <li>● 15/16" (24 mm) wood (mill option) or hardwood laminated to 1" (25 mm) of low-density wood.</li> </ul>
Lite and louver opening	Wood louvers not permitted in 20 minute labeled doors. Minimum 5" (127 mm) from stiles or rails. Minimum 1-1/2" (38 mm) from cut-out to cut-out. Refer to Options Section of our Website for details.
Notes	Stile and rail dimensions shown are rough sizes, before trimming. Dimensions will vary due to prefit requirements.
Warranty	Life of original installation. See our complete warranty for details.
Factory finish	UV Finishing System. Stain, clearcoat, opaque and primed finish available. Custom color matching available. Seal top and bottom standard. <b>No VOC.</b>
Environmental description	Low Emitting Materials ( <b>LEED EQc4.4</b> ). Certified Wood ( <b>LEED MRc7</b> ).



The FSC logo identifies products which contain wood from well-managed forests certified in accordance with the rules of the Forest Stewardship Council.



INFORMATION [WWW.LAMBTONDOORS.COM](http://WWW.LAMBTONDOORS.COM)

