



LAMBTON  
DOORS

COMMERCIAL AND ARCHITECTURAL  
DOOR MANUFACTURER

OPENINGS TO THE WORLD

## DOOR SERIES

# ASSEMBLING INSTRUCTIONS FOR DOORS OVER 48 IN. WIDE (1219 MM)

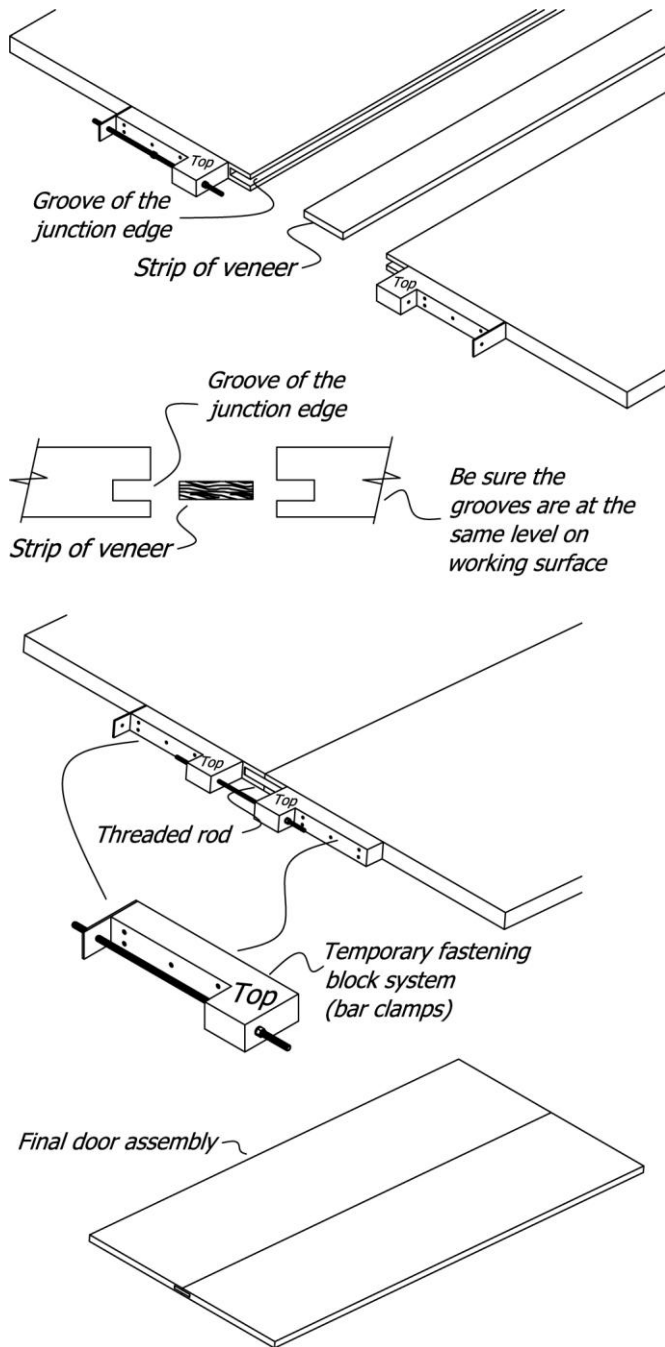

1. To proceed with the door assembly, you will need a Robertson screwdriver #8, two 7/16 in. wrenches and carpenter glue.
2. Horizontal working surface must be clean of all dust or particles that could scratch or damage the door surfaces.
3. As shown at left, put the two panels of the door to be assembled side-by-side with the *grooves of the junction edges* face to face. As illustrated, be sure the *grooves* are at the same level on the working surface.
4. Leave enough space between the two panels in such a manner as to be able to easily insert the supplied *strip of veneer*.
5. Also, be sure the two panels are exactly at the same top and bottom level.
6. Apply carpenter glue into the *grooves of the junction edges*. Avoid any excess of glue. Insert the *strip of veneer* into one of the *groove of the junction edge*. Then join this panel to the second panel of the door.
7. Insert *threaded rods* into the *temporary fastening blocks* used as bar clamps at top and bottom of the panels. Adjust each of them to a reasonable and uniform pressure, not too much.
8. If necessary, wipe off any excess glue from door face with a damp cloth or as per carpenter glue manufacturer's instructions and let it dry.
9. Once dry, as per manufacturer's instructions, remove *threaded rods*, unscrew the *temporary fastening block systems* and recycle them.