

**Lead Lined Door (LSL)**

Standard Series

EnviroDesign™ Series



5-LSL-LL-CE/ME

5-UFLSL-LL-ECE/EME

5-FSLSL-LL-ECE/EME

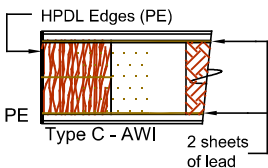
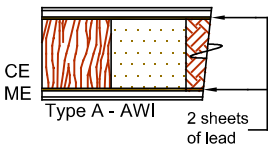
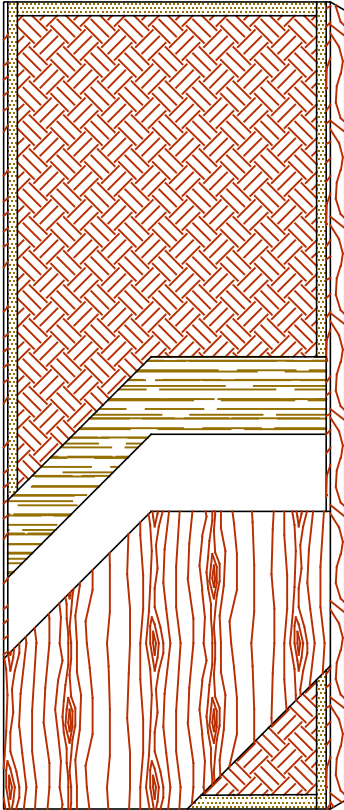

**SPECIFICATIONS DESCRIPTIONS**

<b>Type</b>	Laminated Strand Lumber core (LSL) (interior use).
<b>In Conformity with Industry Standards</b>	ARCHITECTURAL WOODWORK STANDARDS-ED.2 NAAWS 4.0 WDMA Series I.S.1-A-2021 ASTM D5456-09, ASTM F476 ANSI A208.1 - 2016 CSA 0132.2 SERIES 90
<b>Fire Rating Details</b>	20 minutes neutral or positive pressure. Refer to Fire-Rated Options of our Architectural Catalog (e-version). CAN/ULC-S104 NFPA 252 UL 10B neutral pressure UL 10C positive pressure category B UL 10C positive pressure category A in option
<b>Thicknesses</b>	1-3/4" (44 mm).
<b>Maximum Sizes</b>	48" x 96" (1 219 mm x 2 438 mm).
<b>Stiles</b>	<b>CE</b> (Compatible Edge): 15/16" (24 mm) wood (mill option). <b>ME</b> (Matching Edge): 15/16" (24 mm) hardwood. Laminated to 1" (25 mm) Structural Composite Lumber (SCL). <b>PE</b> (Plastic Edge): HPDL edges.
<b>Rails</b>	1 -7/16" (36 mm) Structural Composite Lumber (SCL).
<b>Core</b>	Structural composite lumber (SCL) with a density of 38 PCF (609 kg/m <sup>3</sup> ) bonded to the stiles and rails.
<b>Adhesive</b>	Type I (waterproof); PVA (UF-Free).
<b>Face</b>	Wood veneer, MDO or HPDL laminated to a HDF.
<b>Options</b>	Lead thickness available : 1/16", 1/8" or 1/4" total.
<b>Lite and Louver Openings</b>	Wood louvers not permitted. Lite opening maximum 1 296 in <sup>2</sup> (0.836m <sup>2</sup> ). Non-Rated : Wood beads or lite kit model #115-L2 Rated : Metal kit model #115-L1
<b>Notes</b>	<ul style="list-style-type: none"> <li>• Stile and rail dimensions shown are rough sizes, before trimming.</li> <li>• Available only with 2 sheets of lead : 2 x 1/32" (0.79 mm) = 1/16" (1.59 mm) total. 2 x 1/16" (1.59 mm) = 1/8" (3.175 mm) total. 2 x 1/8" (3.175 mm) = 1/4" (6.35 mm) total.</li> <li>• Lambton Doors recommends the use of heavy duty hinges.</li> </ul>
<b>Warranty</b>	Life of original installation.
<b>Factory Finish</b>	UV Finishing System 9 by AWI. No VOC. Stain, clearcoat, opaque and primed finish available. Sealed top and bottom standard. Custom color matching available. Lambton Doors' <b>ASEPTI</b> : Antimicrobial coated surface in option.
<b>Environmental Benefits</b>	Recycled content. All Series. Regional Materials. According to job site location. FSC Certified Wood. Specify 5-FSLSL. Low Emitting Materials, NAF-ULEF. Specify 5-UFLSL. EPD - Environmental Product Declaration available. HPD - Health Product Declaration available.
<b>Door Weight</b>	Thickness 1-3/4" (44mm) : 9.5 to 20.5 lbs/ft <sup>2</sup> . Will vary depending on the lead thickness



The FSC® logo identifies products which contain wood from well-managed forests certified in accordance with the rules of the Forest Stewardship Council®.