

MODEL 110 FIRE DOOR LIGHT FRAMES

Glazing compound, tape or intumescent **NOT REQUIRED** for label *



COMMERCIAL AND ARCHITECTURAL
DOOR MANUFACTURER

ORDER INFORMATION

- Order size : Inside dimension of frame,
as illustrated (W x H)
- Cut out size : Order size + 1-1/2" [38 mm],
as illustrated ①
- Glass size : Order size + 3/4" [19 mm],
as illustrated ⑥

STD SPECS 18 GA. CRS with beige polyester
powder coating (durable & appealing)

SPECIALS

- 18 GA. Galvanised (Exterior use)
- 18 GA. Stainless steel (Hospital & food services)
- Special colors
- Veneer wrapped

- ① Door cut out size
(W + 1-1/2" [38 mm]) + (H + 1 1/2" [38 mm]).
- ② Frame and glass supports (Included).
- ③ Installation Nail (Included).
- ④ Corner radius acceptable.
- ⑤ Phillips #8 x 1 1/2" sheet metal screw (Included).
- ⑥ Projection welded.
- ⑦ Mounting holes
11" [279 mm] or less :
1 hole centered over 11" [279 mm]
3" [76 mm] max. from corners
11-5/16" [287 mm] max. centers

Glass Note

For non-fire door applications
we recommend 1/4" tempered glass.
If laminated glass is used,
thin glazing and light torque on screws
is required to prevent glass breakage.
Laminated glass **NOT** recommended.

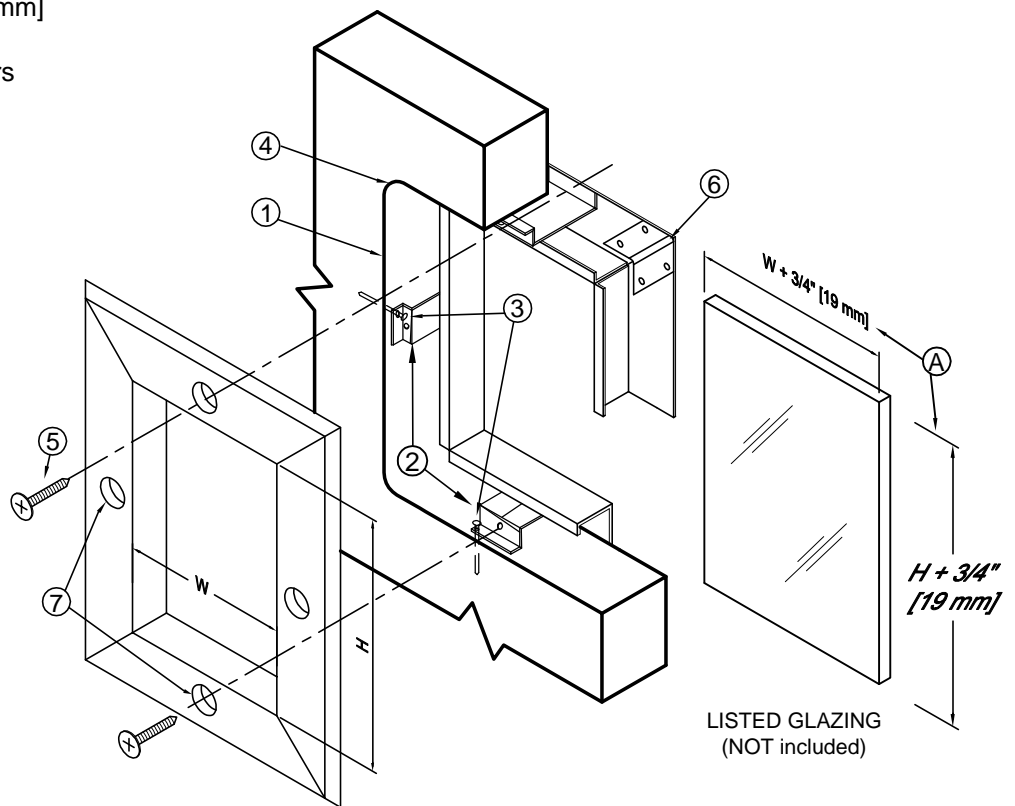
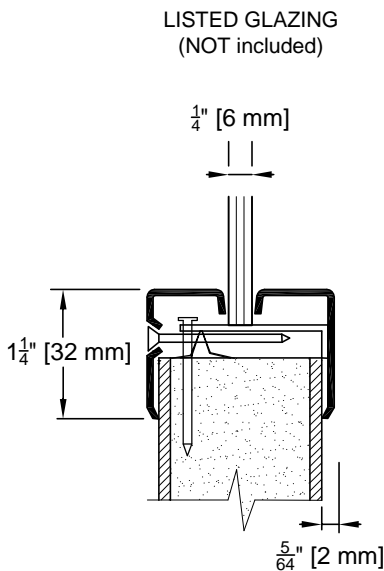

* Glazing compound, tape or
intumescent **NOT REQUIRED**
with the exception
of large light sizes.
See listing specifications.

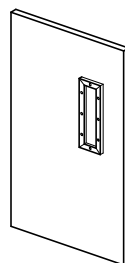

TYPICAL
INSTALLATION

UL & WHI Listed

Meets UL10B requirements for **NEGATIVE PRESSURE**
and UL10C & UBC 7-2 (1997) for **POSITIVE PRESSURE**.
Fire tested with **NO** glazing compound, tape or intumescent.