



COMMERCIAL AND ARCHITECTURAL
DOOR MANUFACTURER

U.S.A. : 1 800 363.2248
Can. : 1 800 463.3124
info@lambtondoors.com
www.lambtondoors.com

HARDWARE, FRAME AND ASTRAGAL ACOUSTICAL DOOR STC45

REQUIRED HARDWARE (by Zero International)

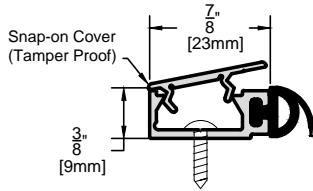

WEATHERSTRIP #475
Install on head and jambs

Specify finish
"AA": Clear Anodized
"D": Dark Bronze Anodized
"G": Gold Anodized

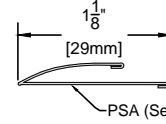

SPRING #119W
Install on head, bottom rail and jambs

Specify finish
"B": Brass
"S": Stainless Steel

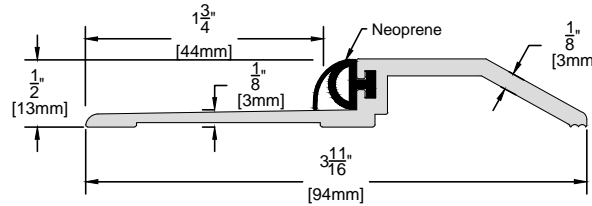

RABETTED THRESHOLD #564A

Specify finish
"A": Aluminum
"B": Bronze
"D": Dark Bronze Anodized

FIELD MEASUREMENTS

Lambton Doors will not be responsible for field measurements.

All STC doors must be undersized 1/2" (13 mm) in total from frame height after finished floor (AFF).

Eg. frame 7'0" (2134 mm):

- Top of door to frame less 1/8" (3 mm)
- Bottom of door to threshold less 3/8" (10 mm)
- Total door to frame difference after finished floor (AFF) less 1/2" (13 mm)

Acoustical door width may be calculated by subtracting 1/4" (6 mm) from inside jamb measurement.

REQUIRED FRAME AND ASTRAGAL

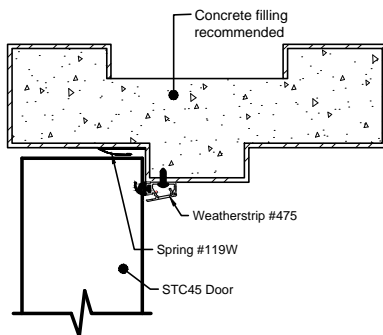

- Any standard hollow metal frame.
- Standard metal frame supplied by others.

FRAME

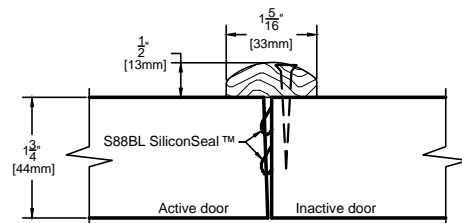

- Gaskets are shown in full size (non-compressed).
- Lambton Doors recommends the use of 1-1/2" [38 mm] brass screws for installation.
- T-Astragal not permitted on fire-rated door.

FLAT WOOD ASTRAGAL