



COMMERCIAL AND ARCHITECTURAL
DOOR MANUFACTURER

U.S.A. : 1 800 363.2248
Can. : 1 800 463.3124
info@lambtondoors.com
www.lambtondoors.com

HARDWARE, FRAME AND ASTRAGAL ACOUSTICAL DOOR STC50

REQUIRED HARDWARE

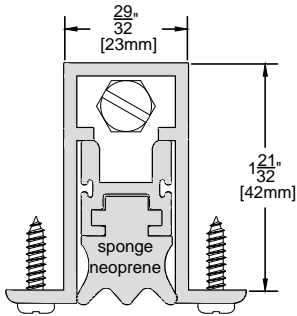

434ARL DROP SEAL

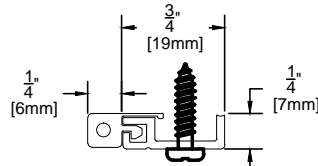

312R PERIMETER GASKETING

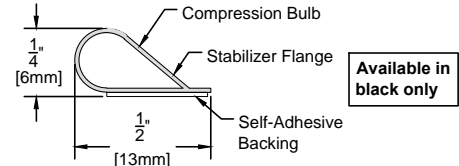

S88BL SILICONSEAL™

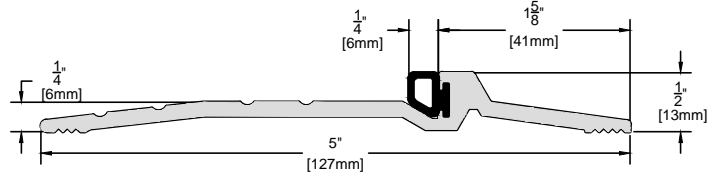

2005AT THRESHOLD

FIELD MEASUREMENTS

Lambton Doors will not be responsible for field measurements.

All STC doors must be undersized 9/16" (14 mm) in total from frame height after finished floor (AFF).

Eg. frame 7'0" (2134 mm):

- Top of door to frame less 1/8" (3 mm)
- Bottom of door to threshold less 3/16" (5 mm)
- Total door to frame difference after finished floor (AFF) less 9/16" (14 mm)

Acoustical door width may be calculated by subtracting 1/4" (6 mm) from inside jamb measurement.

REQUIRED FRAME AND ASTRAGAL

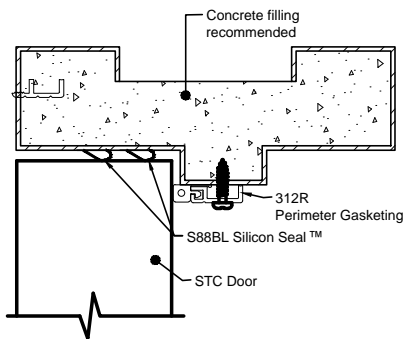

- Any standard hollow metal frame.
- Standard metal frame supplied by others.

FRAME

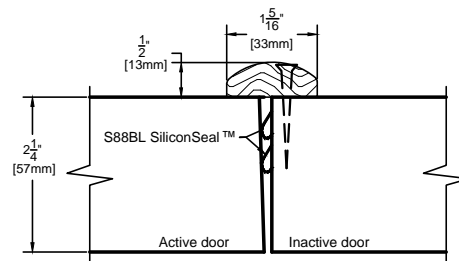

- Gaskets are shown in full size (non-compressed).
- Lambton Doors recommends the use of 1-1/2" [38 mm] brass screws for installation.
- T-Astragal not permitted on fire-rated door.

FLAT WOOD ASTRAGAL