

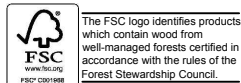

COMMERCIAL AND ARCHITECTURAL
DOOR MANUFACTURER

U.S.A. : 1 800 363.2248
Can. : 1 800 463.3124
info@lambtondoors.com
www.lambtondoors.com

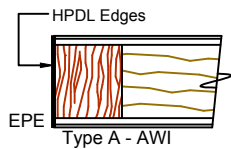
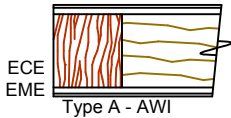
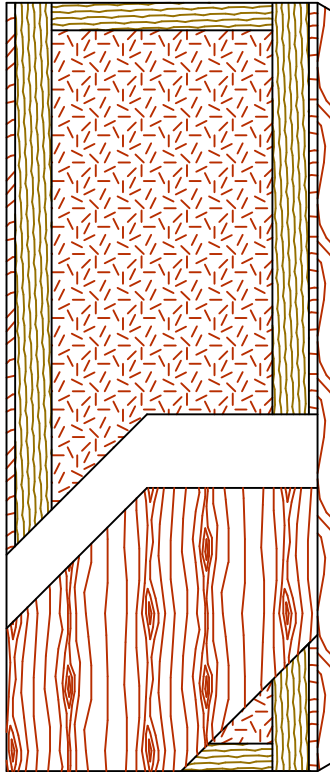

COMMERCIAL AND ARCHITECTURAL DOORS



Acoustical Door NO UREA FORMALDEHYDE

Compatible edge **5-STC45-ECE**
Matching edge **5-STC45-EME**

SPECIFICATIONS DESCRIPTIONS

Type	Sound dampening core (interior use).
In conformity with industry standards	ARCHITECTURAL WOODWORK STANDARDS-ED.2 WDMA Series I.S.1-A-2013 ASTM E413-04 ASTM E2335-04 C.S.A. 0132.2 Serie 90 ASTM E90-04 ASTM E1332-90 ASTM D5456-09
Thickness	1-3/4" (44 mm).
Maximum size	48" x 120" (1 219 mm x 3 048 mm).
Stiles	ECE (Compatible Edge): 15/16" (24 mm) wood (mill option). EME (Matching Edge): 15/16" (24 mm) hardwood. Laminated to 4" (102 mm) structural composite lumber (SCL).
Rails	3" (76 mm) structural composite lumber (SCL).
Core	Proprietary material.
Adhesive	Type I, fully waterproof; PVA (no urea formaldehyde); VOC<0.683 g/L.
Face	Wood veneer or MDO bonded to a UF free composite crossband. No added urea formaldehyde resin.
Acoustical rating	STC45 For pair and transom, STC rating will be affected.
Lite opening	Limited to 1296 Sq. in. (0,836 Sq. m.). Will affect STC rating.
Notes	<ul style="list-style-type: none"> ● Door tested using Zero International hardware. <ul style="list-style-type: none"> ● 1 row of Weatherstrip #475 on doorstops, Specify finish : "AA" : Clear Anodized (in stock). "D" : Dark Bronze Anodized. "G" : Gold Anodized. ● 1 rabbeted Threshold #564A. Specify finish : "A" : Aluminium (in stock). "B" : Bronze. "D" : Dark Bronze Anodized. ● 1 row of Spring #119WB on head and jambs, and on bottom rail of the door. Specify finish : "B" : Brass (in stock). "S" : Stainless Steel. ● The use of hardware other than those tested will affect STC rating. ● Stile and rail dimensions shown are rough sizes, before trimming. Dimensions will vary depending on the hardware. ● For pair and transom, Lambton Doors will provide a wood astragal with S88BL Silicoseal™ gasket. ● Heavy duty hinges must be used. Weight : 11.2 lbs/sq. ft. (54.6 kg/sq. m.). ● Not available fire-rated.
Options	EPE (Plastic Edge): HPDL edge. Lambton Doors' EDGEFENDER : High impact resistant edges.
Warranty	Life of original installation. See our complete warranty for details.
Factory finish	UV Finishing System 9 by AWI. Stain, clearcoat, opaque and primed finish available. No VOC. Custom color matching available. Sealed top and bottom standard. Lambton Doors' ASEPTI : Antimicrobial coated surface in option.
LEED® Credits	MRC4.1, 4.2 : Recycled content. MRC7 : FSC Certified Wood. Available on request. IEQ 4.4 : Low Emitting Materials, UF-Free.