

HARDWARE AND FRAME ACOUSTICAL DOOR STC4520 & STC4545

REQUIRED HARDWARE

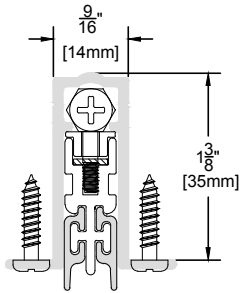

PDB411AE DROP SEAL

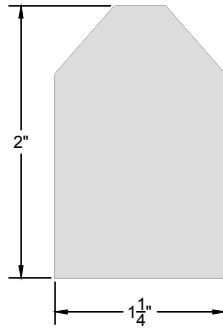

**ACP112 ACOUSTICAL
CORNER PAD**

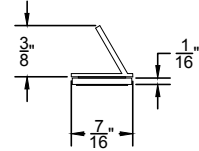

S44BL SILICONSEAL™

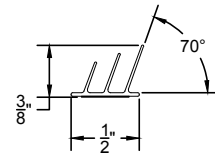

S773 SILICONSEAL™

FIELD MEASUREMENTS

Lambton Doors will not be responsible for field measurements.

All STC doors must be undersized 1/2" (13 mm) in total from frame height after finished floor AFF).

Eg. frame 7'0" (2134 mm):

- Top of door to frame less 1/8" (3 mm)
- Bottom of door to finish floor less 3/8" (10 mm) maximum.
- Total door to frame difference after finished floor (AFF) less 1/2" (12 mm)

Acoustical door width may be calculated by subtracting 1/4" (6 mm) from inside jamb measurement.

REQUIRED FRAME

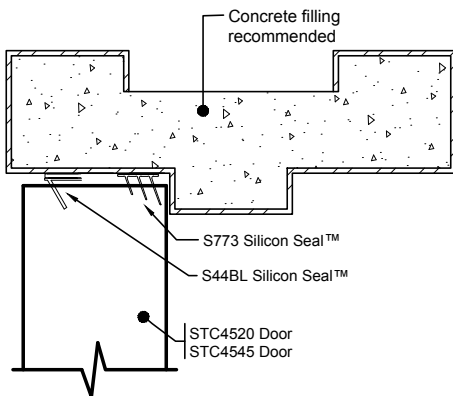

- Any standard hollow metal frame.
- Standard metal frame supplied by others.

FRAME

