

Lead Lined Door (LSL)

Standard Series

EnviroDesign™ Series



5-LSL-LL-CE/ME

5-UFLSL-LL-ECE/EME

5-FSLSL-LL-ECE/EME

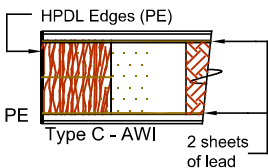
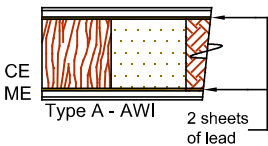
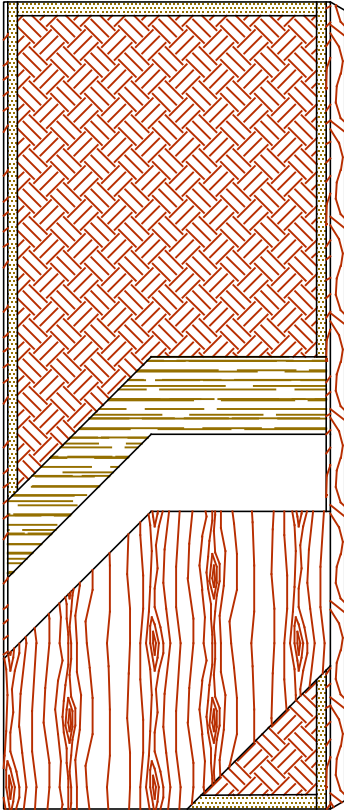

SPECIFICATIONS DESCRIPTIONS

| | |
|--|---|
| Type | Laminated Strand Lumber core (LSL) (interior use). |
| In Conformity with Industry Standards | ARCHITECTURAL WOODWORK STANDARDS-ED.2 NAAWS 4.0 WDMA Series I.S.1-A-2021 ASTM D5456-09, ASTM F476 ANSI A208.1 - 2016 CSA 0132.2 SERIES 90 |
| Fire Rating Details | 20 minutes neutral or positive pressure. Refer to Fire-Rated Options of our Architectural Catalog (e-version). CAN/ULC-S104 NFPA 252 UL 10B neutral pressure UL 10C positive pressure category B UL 10C positive pressure category A in option |
| Thicknesses | 1-3/4" (44 mm). |
| Maximum Sizes | 48" x 96" (1 219 mm x 2 438 mm). |
| Stiles | CE (Compatible Edge): 15/16" (24 mm) wood (mill option). ME (Matching Edge): 15/16" (24 mm) hardwood. Laminated to 1" (25 mm) Structural Composite Lumber (SCL). PE (Plastic Edge): HPDL edges. |
| Rails | 1 -7/16" (36 mm) Structural Composite Lumber (SCL). |
| Core | Structural composite lumber (SCL) with a density of 38 PCF (609 kg/m ³) bonded to the stiles and rails. |
| Adhesive | Type I (waterproof); PVA (UF-Free). |
| Face | Wood veneer, MDO or HPDL laminated to a HDF. |
| Options | Lead thickness available : 1/16", 1/8" or 1/4" total. |
| Lite and Louver Openings | Wood louvers not permitted. Lite opening maximum 1 296 in ² (0.836m ²). Non-Rated : Wood beads or lite kit model #115-L2 Rated : Metal kit model #115-L1 |
| Notes | <ul style="list-style-type: none"> Stile and rail dimensions shown are rough sizes, before trimming. Available only with 2 sheets of lead : 2 x 1/32" (0.79 mm) = 1/16" (1.59 mm) total. 2 x 1/16" (1.59 mm) = 1/8" (3.175 mm) total. 2 x 1/8" (3.175 mm) = 1/4" (6.35 mm) total. Lambton Doors recommends the use of heavy duty hinges. |
| Warranty | Life of original installation. |
| Factory Finish | UV Finishing System 9 by AWI. No VOC. Stain, clearcoat, opaque and primed finish available. Sealed top and bottom standard. Custom color matching available. Lambton Doors' ASEPTI : Antimicrobial coated surface in option. |
| Environmental Benefits | Recycled content. All Series. Regional Materials. According to job site location. FSC Certified Wood. Specify 5-FSLSL. Low Emitting Materials, NAF-ULEF. Specify 5-UFLSL. EPD - Environmental Product Declaration available. HPD - Health Product Declaration available. |
| Door Weight | Thickness 1-3/4" (44mm) : 9.5 to 20.5 lbs/ft ² . Will vary depending on the lead thickness |



The FSC® logo identifies products which contain wood from well-managed forests certified in accordance with the rules of the Forest Stewardship Council®.