



COMMERCIAL AND ARCHITECTURAL
DOOR MANUFACTURER

U.S.A. : 1 800 363.2248
Can. : 1 800 463.3124
info@lambtondoors.com
www.lambtondoors.com

COMMERCIAL AND ARCHITECTURAL DOORS



Acoustical Door NO UREA FORMALDEHYDE

Compatible edge **5-STC35-ECE**
Matching edge **5-STC35-EME**
Blind edge **5-STC35-EBE**

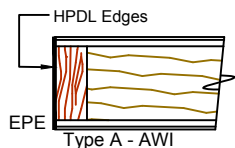
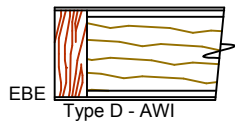
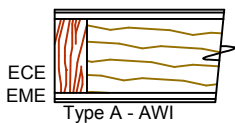
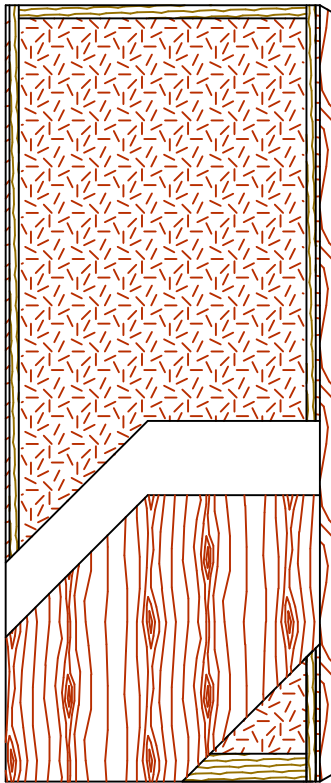

SPECIFICATIONS DESCRIPTIONS

Type	Sound dampening core (interior use).
In conformity with industry standards	ARCHITECTURAL WOODWORK STANDARDS-ED.2 WDMA Series I.S.1-A-2013 ASTM E90-04 ASTM E413-04 ASTM E1332-90 ASTM E2235-04 ASTM D5456-09 C.S.A. 0132.2 Serie 90
Thickness	1-3/4" (44 mm).
Maximum size	48" x 120" (1 219 mm x 3 048 mm).
Stiles	ECE (Compatible Edge): 7/16" (11 mm) wood (mill option). EME (Matching Edge): 7/16" (11 mm) hardwood. EBE (Blind Edge): 7/16" (11 mm) hardwood. Laminated to 1" (25 mm) of proprietary material.
Rails	Top: 1-7/16" (37 mm) of proprietary material. Bottom: 3" (76 mm) of proprietary material.
Core	Proprietary material.
Adhesive	Type I, fully waterproof; PVA (no urea formaldehyde); VOC<0.683 g/L.
Face	Wood veneer or MDO bonded to a UF free composite crossband. No added urea formaldehyde resin.
Acoustical rating	STC35. For pair and transom, STC rating will be affected.
Lite opening	Limited to 1 296 Sq. in. (0,836 Sq. m.). Will affect STC rating.
Notes	<ul style="list-style-type: none"> ● Doors tested using double S88BL Siliconeal™ gasket, 434ARL drop seal, 2005AT threshold and 3 heavy duty hinges. The use of hardware other than those tested will affect STC rating. ● Stile dimensions shown are rough sizes, before trimming. Dimensions will vary depending on the hardware. ● For pair and transom, Lambton Doors will provide a wood astragal with S88BL Siliconeal™ gasket. ● Heavy duty hinges must be used. Weight : 9.4 lbs/sq. ft. (45.8 kg/sq. m.). ● Not available fire-rated. Refer to STC35-90 in such a case.
Options	15/16" (24 mm) wood (mill option) or hardwood laminated to 1" (25 mm) of proprietary material. EPE (Plastic Edge): HPDL edge. Lambton Doors' EDGEFENDER : High impact resistant edges.
Warranty	Life of original installation. See our complete warranty for details.
Factory finish	UV Finishing System 9 by AWI. Stain, clearcoat, opaque and primed finish available. No VOC. Custom color matching available. Sealed top and bottom standard. Lambton Doors' ASEPTI : Antimicrobial coated surface in option.

LEED® Credits



MRc4.1: Recycled content.
MRc7: FSC Certified Wood. Available on request.
IEQ 4.4: Low Emitting Materials, UF-Free.

The FSC logo identifies products which contain wood from well-managed forests certified in accordance with the rules of the Forest Stewardship Council.

The mark of responsible forestry

